

ROYSON ENGINEERING COMPANY

130 N. PENN ST. HATBORO, PA. 19040 PHONE #215-675-2800 FAX#215-675-3035
 CDT-IS BOWL TYPE VIBRATORY HEATED COB DRYER WITH RISING CHANNEL
 BULLETIN #793

15-CDT-IS

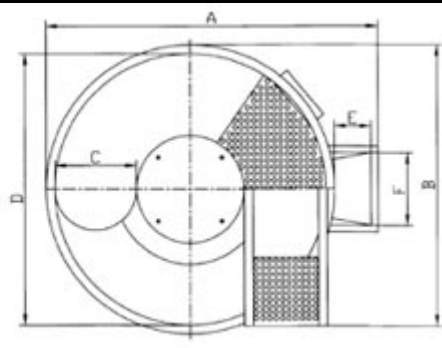
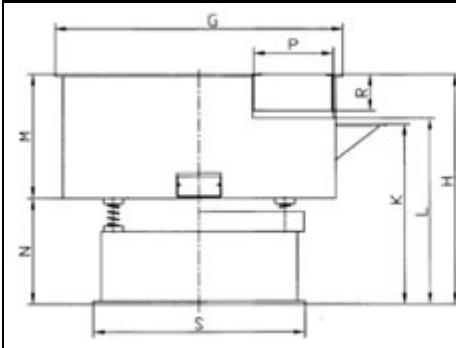

DIM. INCHES	A	B	C	D	E	F	G	H	K	L	M	N	P	R	S	WEIGHT
	66	48	16.7	64.5	9	23	60	45	34	35	25	19	17	8	60	2270 LBS

OPTIONAL STEEL DUST COVER



- THE 15-CDT-IS COB DRYER IS AN EXCELLENT CHOICE FOR COB DRYING PARTS IN A CONTINUOUS MODE BY SIMPLY CLOSING OFF A SECTION OF THE SCREEN DECK. THE WIDE LOAD CHUTE ALLOWS EASY LOADING OF PARTS INTO THE MACHINE.

- 15 CUBIC FOOT CAPACITY
- 3600 WATT VIBRATION PROOF HEATING ELEMENT MOUNTED UNDER THE SCREEN DECK.
- 5.3 HP MOTOR, VARIABLE SPEED DRIVE

CONTROL PANEL 208/240/460/3/60



Copyright/2010