

ROYSON ENGINEERING COMPANY

130 N. PENN ST. HATBORO, PA. 19040 PHONE #215-675-2800 FAX#215-675-3035
 CDT-IS BOWL TYPE VIBRATORY HEATED COB DRYER WITH RISING CHANNEL
 BULLETIN #790

2.5-CDT-IS

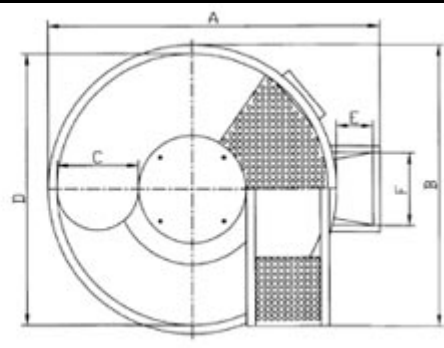
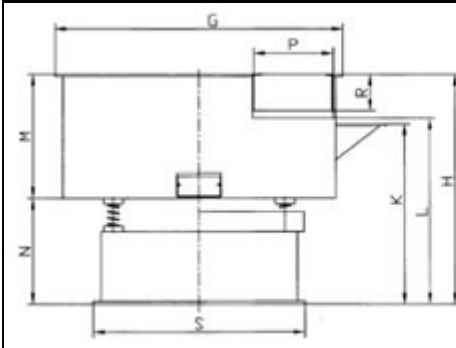
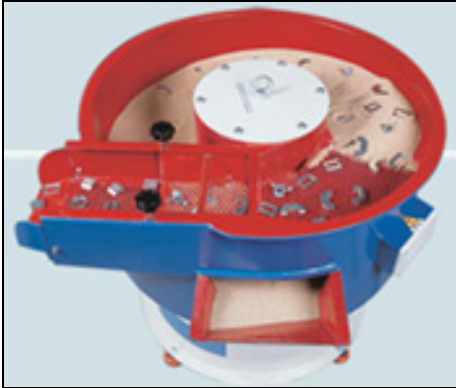

DIM. INCHES	A	B	C	D	E	F	G	H	K	L	M	N	P	R	S	WEIGHT
	43	30	9.8	34	7	11.8	37	33.8	27	27	15.7	18	10	5	30	740 LBS

OPTIONAL STEEL DUST COVER



• THE 2.5-CDT-IS COB DRYER IS AN EXCELLENT CHOICE FOR COB DRYING PARTS IN A CONTINUOUS MODE BY SIMPLY CLOSING OFF A SECTION OF THE SCREEN DECK. THE WIDE LOAD CHUTE ALLOWS EASY LOADING OF PARTS INTO THE MACHINE.

- 2.5 CUBIC FOOT CAPACITY
- 1500 WATT VIBRATION PROOF HEATING ELEMENT MOUNTED UNDER THE SCREEN DECK.
- 1.4 HP MOTOR, VARIABLE SPEED DRIVE

CONTROL PANEL 208/240/460/3/60



Copyright/2010